

DOCKSY FRONT

MEET: DOCKSY

No need for cluttered cords with Docksy! The 3-in-1 charging dock.

Docksy charges your Apple Watch®, smartphone and AirPods® all at once!



Docksy Anatomy



Safety Warnings and Legal Information

- Do not disassemble Docksy
- Keep Docksy away from water and out of extreme heat
- Keep Docksy away from strong magnetic fields
- Use the proper power adapter (9V, 1.67A or above)
- If Docksy overheats, remove your phone and unplug devices immediately. Docksy may shut off on its own if it becomes too hot. Wait until Docksy is completely cooled off to use Docksy again.

Docksy complies with part 15 of the FCC rules. Operation is subject to the following two conditions: (1) This device may not cause harmful interference, and (2) this device must accept any interference received, including interference that may cause undesired operation.

Caution: Changes or modifications not explicitly approved by the party responsible for compliance could void the authority of the user to operate this device.

NOTE: Docksy has been tested and found to comply with the limits for a Class B digital device, pursuant to part 15 of the FCC Rules. These limits are designed to provide reasonable protection against harmful interference in a residential installation. This equipment generates, uses, and can radiate radio frequency and if not installed and used in accordance with the instructions, may cause harmful interference to radio communications. However, there is no guarantee that interference will occur. If Docksy does cause harmful

interference to radio or television reception, which can be determined by turning the equipment off and on, the user is encouraged to try to correct the interference by trying one or more of the following measures:

- Reorient or relocate the receiving antenna
- Move the equipment and the receiver further apart from one another
- Plug the equipment into an outlet on a different circuit from the one that the receiver is connected to.
- Consult a technician

Operate Docksy

Install Docksy

(Wall adapters, AirPods® and Apple Watch® charging cables not included with Docksy.)

1. Use a 1 ft, 3 ft or 6 ft Apple Watch® charging cable.
2. Remove Docksy's tower to reveal built-in USB ports.
3. Place the charging cable in the provided opening and plug into one of the USB ports.
4. Plug the standard Lightning® cable into other USB port and hide the excess cable inside the tower.
5. Place the head of the Lightning® cable through the opening in the provided cover.
6. Plug the hub into a wall outlet with the provided USB-C cable.

Wireless Charging

- Use a wall adapter or USB port that is 1A - 2.4A for optimal charging speeds.
- We recommend against using any USB ports that produce under 1A.
- Use only USB-C cables to power Docksy.
- Use computer USB ports under 1A.

Troubleshooting



INCORRECT PLACEMENT



CORRECT PLACEMENT

- If you are experiencing issues with wireless charging, make sure your phone is centered on the charger (See image above)
- If you are experiencing slow charging, be sure to use a USB port or a wall adapter that is rated for 1A or above (2.4A max)
- Computer USB ports are typically under 1A

Product Specs

Package contains: 3-in-1 Accessories Charger (1), USB-C to USB-A cable (1), User Manual (1)
 Wireless charger compatibility: iPhone X, iPhone 8 Plus, iPhone 8, Samsung Galaxy S8, & Note 8 and Newer.
 Input: 5V 2A USB-C Port
 Output: 5V/0.5A for USB 1, 5V/0.5A for USB2
 Wireless Output: 5W/7.5W/ 10W
 For Max Charging Speed Use: 2.4AAC Adapter
 Product Weight: 0.74 lbs
 Product Dimensions: 8in x 6in x 6in
 Apple Watch® cable is not included. Docksy will only charge through cases 5MM thick or less.

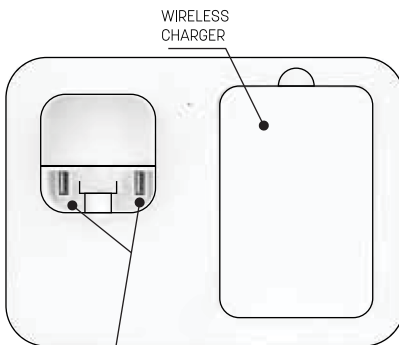

BUILT-IN USB PORTS

Lightning® CABLE PORT OPENING



Origaudio

www.origaudiopromo.com

© 2019 Forty Four Group, LLC., d/b/a Origaudio · Printed in California · Made in China

AirPods® and Apple Watch® are the registered trademarks of Apple Inc.

Apple Inc. is not in any way associated with or endorsed by Forty Four Group, LLC., d/b/a Origaudio

