

HOVINGTON FLYING CAMERA

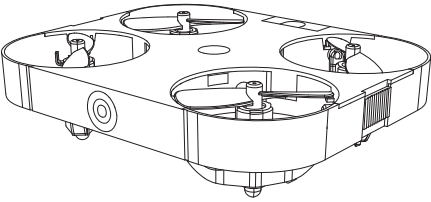

USER MANUAL

KNOW YOUR HOVINGTON

The Hovington camera drone offers full control for all directions and features such as altitude hold, flips and rolls, and speed switch. It also has an automatic Optical Positioning Function built in, which assists the drone in adapting to whatever terrain it's flying over to ensure a stable flight!

Please read this manual carefully before operation to ensure safety of yourself and others, and to better understand the Hovington's awesome features.

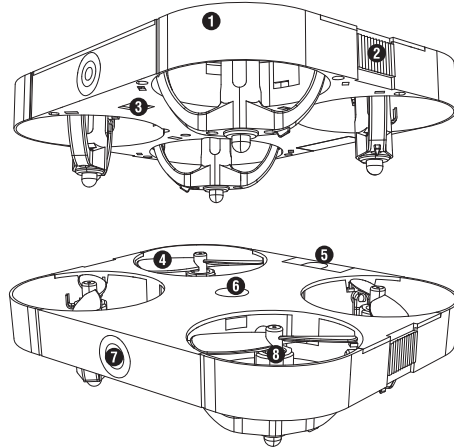

- | | |
|------------------------|-----------------|
| 1. Casing | 5. Battery |
| 2. Unfold Button | 6. Power Button |
| 3. Optical Flow Sensor | 7. Camera |
| 4. Propeller | 8. Motor |

2. Battery Charging

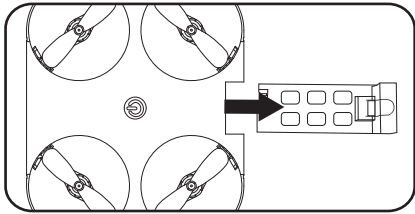

A. Remove the battery unit from the back of the Hovington.

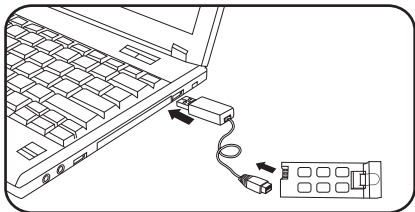

B. Connect the USB charging cable with the charging interface of the lithium battery.

The LED light turns on during charging and turns off when charging is complete. It takes about 45 minutes to achieve a full charge, which amounts to about 5 minutes of running time.

3. Propeller Repair/Replacement

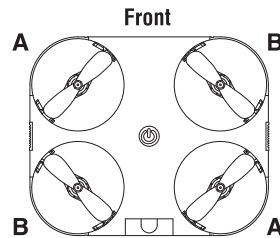

A corresponds to A
B corresponds to B

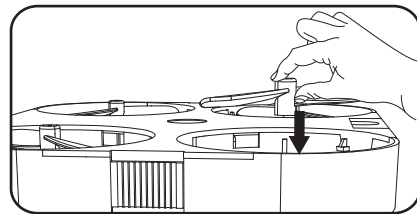

To install, hold the propellers & align to the crankshaft.

Tip: When dismantling the propeller, firmly grip the piece and slowly lift it off the motor. Please refrain from exerting force to avoid distortion.

INCLUDED ACCESSORIES

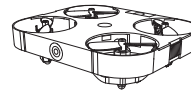

Hovington Drone



Hovington
Removable Battery

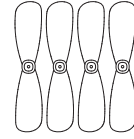

Backup Propeller (x4)

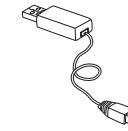

Micro-USB
Charging Cable

SPECS

Flight Time on a Full Charge: Approx. 5+ min

Battery: 3.7 V; 400 mAh li-poly

Camera Resolution: 720P HD

Flying Distance: Up to 65 ft.

Wireless Frequency Band: 2.4 GHz

Charging Time: Approx. 45 min

⚠ BATTERY INSTRUCTIONS

- There is a certain risk when using any lithium battery. It may cause fire, body injury or property loss. Users must be aware of the risks and take full responsibility of improper battery use.
- If battery leakage occurs, please avoid contact with your eyes or skin. If contact does happen, please wash your eyes with clean water and seek medical care immediately.
- Please remove the plug immediately if you sense any unusual smell, noise or smoke.

Battery Charging

- Please use the original charger provided in the packaging to ensure safe usage.
- Do not overcharge the battery. Please unplug the charge once the battery is fully charged.
- Do not charge the battery next to flammable items such as carpet, wood floors or wood furniture, or on the surface of electro-conductive objects. Please always keep an eye on the battery when charging.
- Please do not charge the battery if it is still warm to the touch.
- The battery should only be charged in environment temperatures between 32-104°F (0-40°C).

Battery Recycling

- Please do not dispose the battery in the garbage. Please dispose the battery at your local household hazardous waste disposal facility or an authorized recycling facility.

PRE-FLIGHT PREPARATION

1. Flight Environment



Indoor: Spacious area away from barriers, crowds, or pets is preferred.



Outdoor: Sunny, windless, or slight breezy weather is preferred.



Please keep the device in sight during flight, and keep it away from barriers, high-tension cables, trees, and people.



Do not fly in extreme weather or environments such as extreme heat, strong wind, or heavy rain.

CONNECTING TO THE APP

Download the JJRC app (the red icon) on an iOS or Android device.



1. Hold the power button on top of the Hovington device until lights flash to turn it on.
2. Go to your WiFi settings on your smart device and make sure WiFi is turned on.
3. Connect to the "Hovington-xxxx" WiFi network to pair with your Buddyfly.

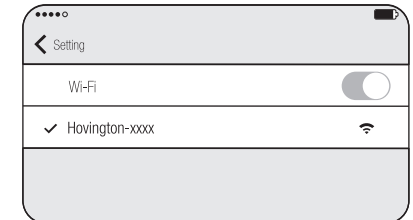

4. Open the JJRC app on your device.
5. Click "Connect" and you will now see the main user interface.

Note: After connecting to the appropriate WIFI above, you may get a notification that "Internet may not be available." This is normal, as this just indicates that the connection is for a drone controller and not a connection with your internet modem.

APP INTERFACE

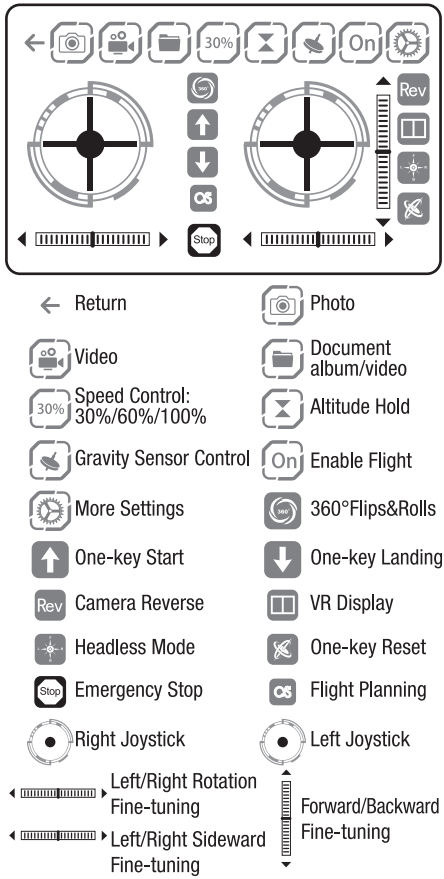

APP INTERFACE: Figure 1

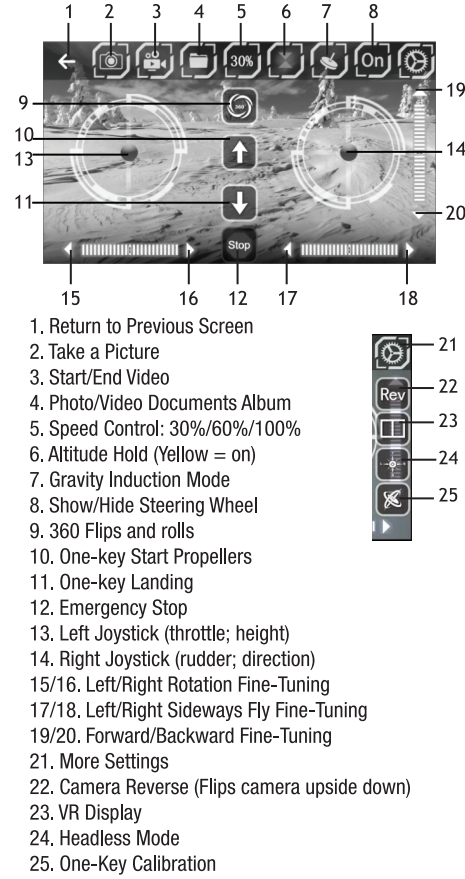

LIFT OFF/LANDING

- After connecting to the app, press the On/Off button to display the steering wheel controls and enable flight.
- Activate Altitude Hold to pair remote control frequency and hover the drone at a stable height. The altitude will be held at the height of which you release the left joystick in ascent/descent action.

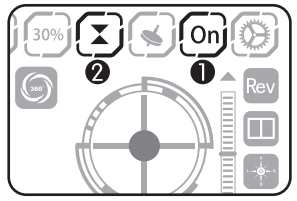

To Lift Off

- Press the One-Key Start button. This will turn on the motors and propellers, but will not lift the device off the ground.

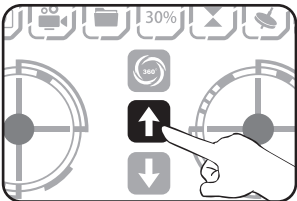

- Slowly slide your finger upwards on the left joystick (see Figure 1.13) to increase the throttle and lift the device off the ground.

LIFT OFF/LANDING (cont.)

- To decrease throttle and lower the device, slide finger downwards on the left joystick.

To Land

- Press the One-Key Down button (Figure 1.11) one time and wait for the Hovington to slowly lower and automatically turn off its motor.
- Alternatively, you can slowly decrease the throttle to lower the device, and press the emergency stop button (Figure 1.12) when it is less than 1 foot off the ground.

Please Note:

- Fly the device at least 1 foot off the ground. When too close to the ground, it creates a vortex that makes flight unstable.
- If you receive an incoming phone call while flying, the Hovington will slowly auto-land and close the app interface.
- If you crash-land:
 - Please practice and improve your flying skills to avoid damage.
 - You may need to close and re-open the app and re-pair the Buddyfly to your smart device.

JOYSTICK CONTROLS

Use the LEFT joystick to control the flight altitude and rotate left/right.

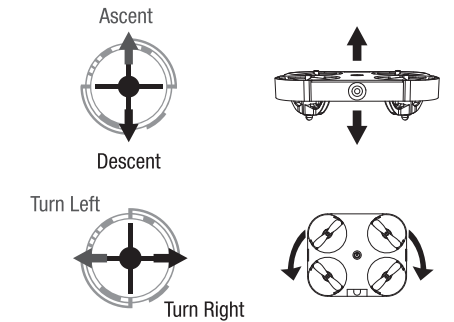

Use the RIGHT joystick to control the forward, backward, and left/right sideways flight.

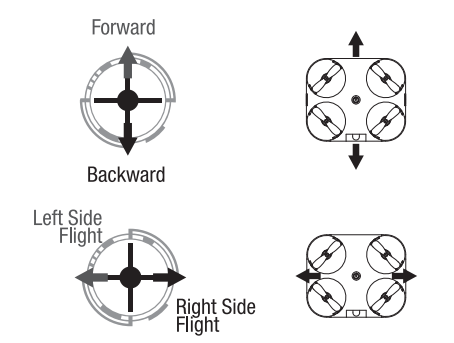

FINE-TUNE CONTROLS

If the device rotates or tilts, use the "Fine-Tuning" buttons (Figures 1.15 - 1.20) to correct and adjust the movement of the device.

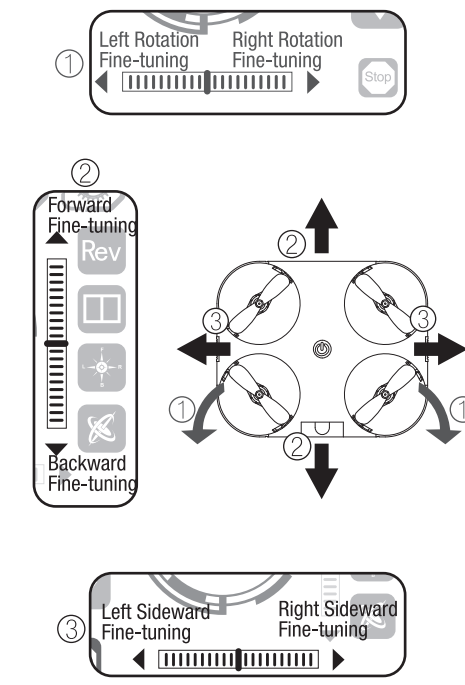

GRAVITY SENSOR CONTROL

We recommend activating and flying with this setting, especially for beginners.

Activate Gravity Sensor Control (Figure 1.7) to fly without using the joysticks. Keep your thumb on the right joystick, and tilt your phone in any direction for remote control flight.

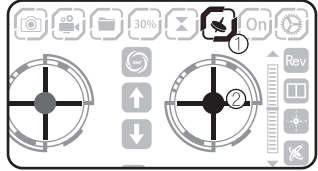

FLIPS & ROLLS

When the device is more than 10 feet high, click the 360° Flips & Rolls button (Figure 1.9) and pull the right joystick to any direction to make the device flip/roll that direction.

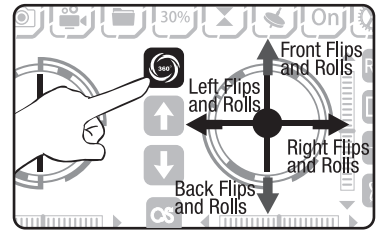

TAKING PHOTOS AND VIDEO

- Master your flying skills before taking photos with the Hovington flying camera.
- Make sure Altitude Hold (Figure 1.6) is activated so your device will stabilize and hover. The button turns yellow to indicate it is on.
- Use the joysticks and fine-tuning buttons to fly and position the device to the desired spot for your photo.
- Use the app interface on your mobile device to view what the camera is capturing.
- Press the camera button (Figure 1.2) to snap the picture. It will go straight to your phone's photo album and the Documents Photo/Video Album (Figure 1.4).
- To take a video, press the video camera button and it will begin recording.

HEADLESS MODE

Activate Headless Mode (Figure 1.24) to fly easily without knowing the direction your Hovington is facing. Device movements will be relative to the app interface controls.

